

KIT PRODUCT TECHNICAL DATASHEET

KIT BH30/805

Brushless 

Intensive use 

Digital Encoder 

Mechanic limit switch 



Composition KIT BH30/805

CODE	DESCRIPTION	QTY
BH30/803	Electromechanical BRUSHLESS motor, low voltage, super intensive use, with native encoder onboard, irreversible ideal for sliding gates up to 800-1000 kg. with built-in digital controller B70 series, mechanical limit switch.	1
H93/RX22A/I	Plug-in receiver 2 channels 433,92 Mhz (500 Storable codes) for control unit series H70, B70, EDGE and CTRL.	1
SYNUS/2	Dual code transmitter (modality fixed code or rolling code), 433,92 Mhz. 2 channels, with radio for copy.	2
R90/F4ES	Pair of external photocells synchronized 24V AC/DC (max. 4 pairs).	1
FIFTHY/24	LED flashing light series FIFTHY 24V with integrated antenna.	1
R99/C/001	Signboard "Automatic Opening"	1

PRODUCT TECHNICAL SPECIFICATIONS

Max gate weight	800-1000 kg
Power line supply	230V AC - 50Hz
Motor power supply	24V
Power rating	200W
Frequency of use	Intensive use
Thrust	50 - 1000N
Operating temperature	-20+55°C
Protection level	IP43
Reductor Type	Irreversible
Manoeuvre speed	12 m/min (0.20 m/s)
Limit switch	Mechanical limit switch

Onboard control unit	B70/1DC
Encoder	Digital native encoder + magnetic digital SENSORED, 4096 PPR
Batteries recovery	Optional 2 internal battery 12V 1,2AH - Optional 2 external battery 12V 4,5AH
Type exit gear	Z15/mod 4
Operating cycles per day (opening/closing - 24 hours no stop)	1300
Maximum dimension product in mm (L x W x H)	315 x 165,8 x 329
Product weight packed (Kg)	12,5
Number items per pallet	44

PRODUCT DIMENSIONS AND PREPARING FOR INSTALLATION

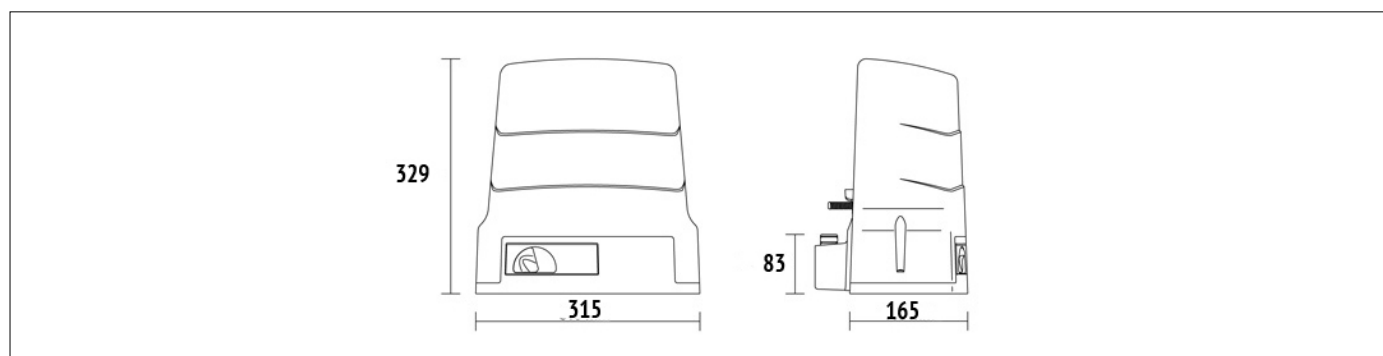

DIMENSIONS

PRODUCT PREPARING FOR INSTALLATION

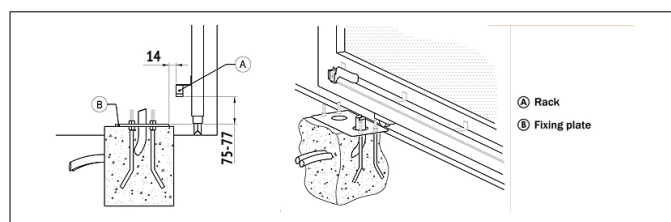

PREDISPOSITION FOR STANDARD INSTALLATION

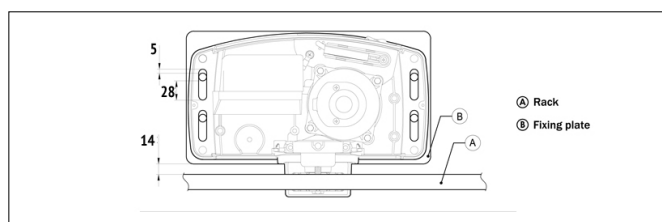

PREDISPOSITION FOR STANDARD INSTALLATION

PRODUCT ACCESSORIES



B71/PBX24/BOX
Battery chargers with solar panels for powering Brushless digital controllers at 24V DC in network mode



B71/PBX24/BOX/115
Battery chargers with solar panels for powering Brushless digital controllers at 24V DC in network mode

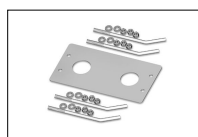

KT214
Fixing plate with stay bolts and screws H30 series.

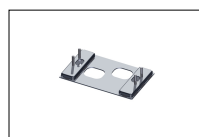

KT214/SC
Adapter plate with stay bolts and screws H30 series.

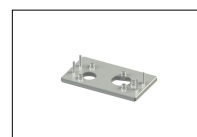

KT214/SF
Adapter plate with stay bolts and screws H30 series.



KT214/SN
Adapter plate with stay bolts and screws H30 series.



KT221
Raised fixing plate for H30 series (+3,5 cm).



HT418
External box without batteries, for battery BT12V45 (12V DC 4,5 Ah)



GA550
Galvanised steel rack 22x22x1000 module 4.



GA551
Galvanised steel rack 30x12x1000 module 4 with spacers and screws.



GA554
Pocket of 6 spacers (2,5 Cm) and screws.

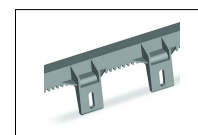

GA553
Nylon rack module 4 with 6 connectors L1000.



GA557
Roger Technology nylon rack module 4 with 6 connectors L1000.



LT330
Chain drive kit for H30 BH30 series.



LT334
1/2" X 5/16" 5 meter chain piece for LT330 with joint.

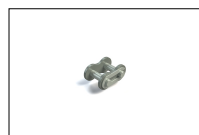

LT335
1/2" X 5/16" joint for LT334 chain section.

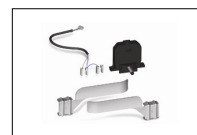

MC773
Kit mechanical limit switch for control unit H70/103AC, H70/104AC, B70/10C, B70/10CHP.