

# Twister light

## Electromechanical tripod turnstiles



### The ideal solution for selecting pedestrian transit in high-intensity flow situations - ready to fit a transponder

- The practical and functional turnstile for managing high-flow rates
- Ideal for installing at train stations, ports and metro stations, sports facilities and stadiums, where entrance and exit operations need to be optimised.
- Perfectly integratable with Came access control systems.

### Dimensions (mm)

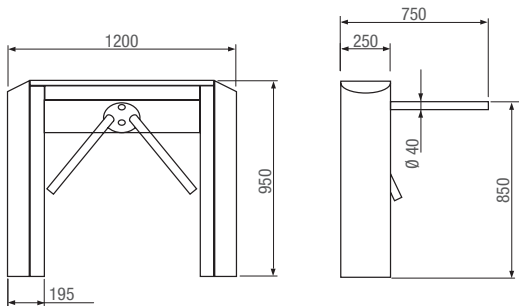

### Application (mm)

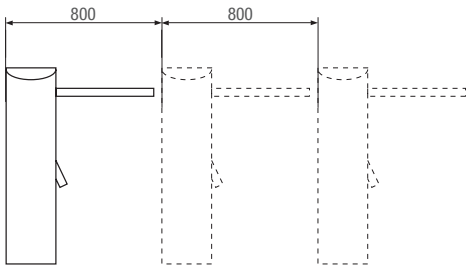

### Technical features

|                               |                     |
|-------------------------------|---------------------|
| Type                          | PSBPS07N            |
| Power supply (V)              | 230 AC              |
| Operating power (V)           | 24 DC               |
| Current draw (A)              | 2.5                 |
| Weight (Kg)                   | 60                  |
| Operating temperature (°C/°F) | -20 ÷ +55/-4 ÷ +131 |

● 230 V AC

# The complete range



| Code  | Description  |
|---|--|
| <b>Electromechanical tripod turnstiles</b>                  |  |
| 001 <b>PSBPS07N</b>   | Electromechanical bi-directional turnstile made of AISI 304 steel with scotch-brite finish. Complete with control board and hydraulic damper. Automatic tripod release in case of blackouts. |
| <b>Accessories for: electromechanical tripod turnstiles</b> |  |
| 001 <b>PSOPSC01</b>   | Antipanic rods with pressure joints.   |
| 001 <b>PSOPG01</b>  | Channeler complete with galvanized metal flange riser, plastic flange cover and AISI 304 stainless steel post with arc 1,000 mm / 39.37 in.  |
| 001 <b>PSOPG01X</b>   | Channeler complete with AISI 304 stainless steel flange riser, flange cover and post with arc 1,000 mm / 39.37 in.   |
| 001 <b>PSPEBUL</b>  | Plate with anticorodal structure and rice-grain aluminium walkway. To couple with Top series barriers and modular barriers.  |
| 001 <b>PSOPCN03</b>   | Electronic counter.  |
| 001 <b>PSOPSF03</b>   | Bi-directional traffic light with high-luminosity LED.   |

