

SL-200M Mortise Type Electromagnetic Lock Installation Instruction

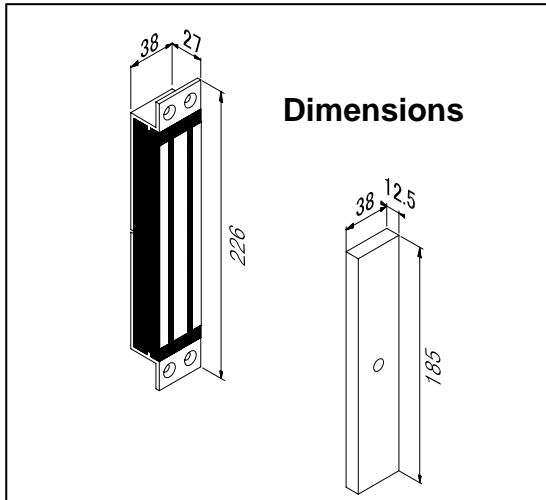

Series Model:

SL-200M : Monitor is not available.

SL-200MR : With lock status monitor output.

Specification:

	SL-200	SL-200M	Notes
Power supply	DC 12V/DC 24V		± 15%
Operation current	450mA@12VDC / 235mA@24VDC		± 5%
Lock status	N.C. output		Reed switch
Application	Out-swing door/In-swing door/Sliding door		
Holding forces	600lbs		
Operation temperate	40°C ± 5°C (linside air temperature 30°C)		
Warranty	The warranty is 2 years for normal using		
Weight	2kg		

Accessories diagram :

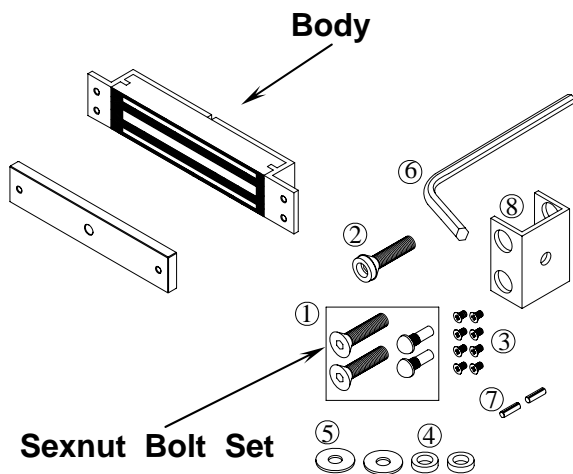

Accessories:

No.	Model type		SL-200 / SL-200M	Note
	Type	Quantity		
1	Sexnut Bolt Set	2		
2	Screw 8X35mm	1		
3	Screw 5X8mm	8		
4	Rubber washer	2		
5	Washer	2		
6	5mm Allen key	1		
7	Guide pins	2		
8	Bracket	1		

Wiring Diagram:

DC12V :

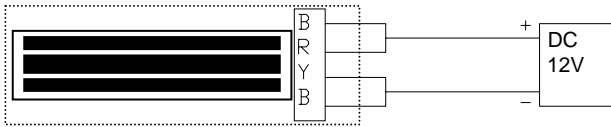

Wire color

DC24V :

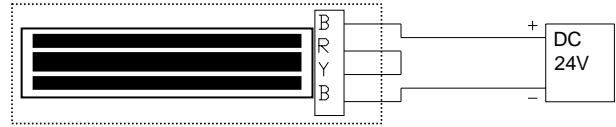

Wire color

Installation diagram:

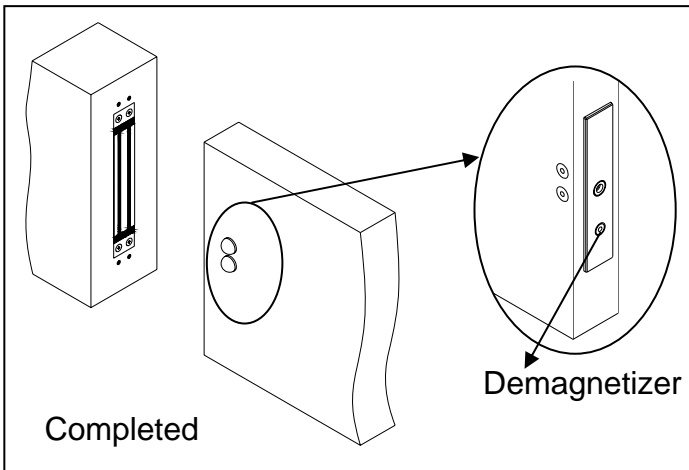
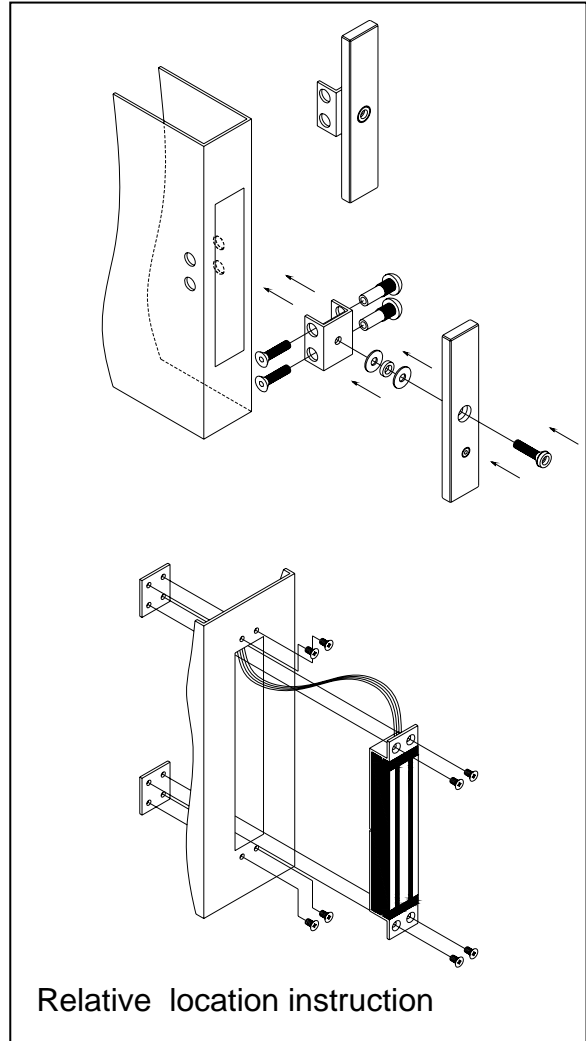
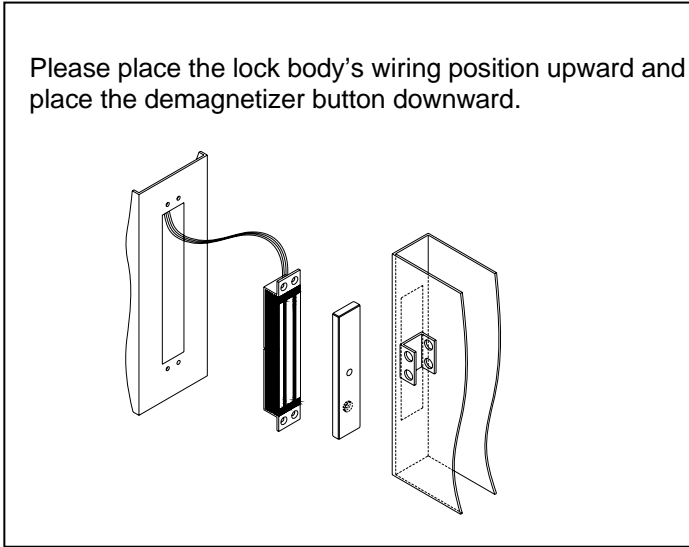

Question & answer	
◆	Door is not locked tightly.
	1.Check if the voltage is correct. 2.Check if the setting of voltage is correct. 3.Check if the magnetic lock and armature are engaged tightly.
◆	Lock status monitor output is error.
	1.Check if the armature is mounted to the correct position. 2.Check if the voltage is set correctly. Any dust or rust will affect the operation of the lock.
◆	Maintenance of the magnetic lock.
	1.Any dust or rust should be removed regularly. 2.Lubricant should be apply on the magnetic lock to avoid any rust depending on the environment it is installed (such as seaside).